

# STAY-FORM

The Stay-in-Place Concrete Form

## BOX BEAM CAVITIES WITH STAY-FORM

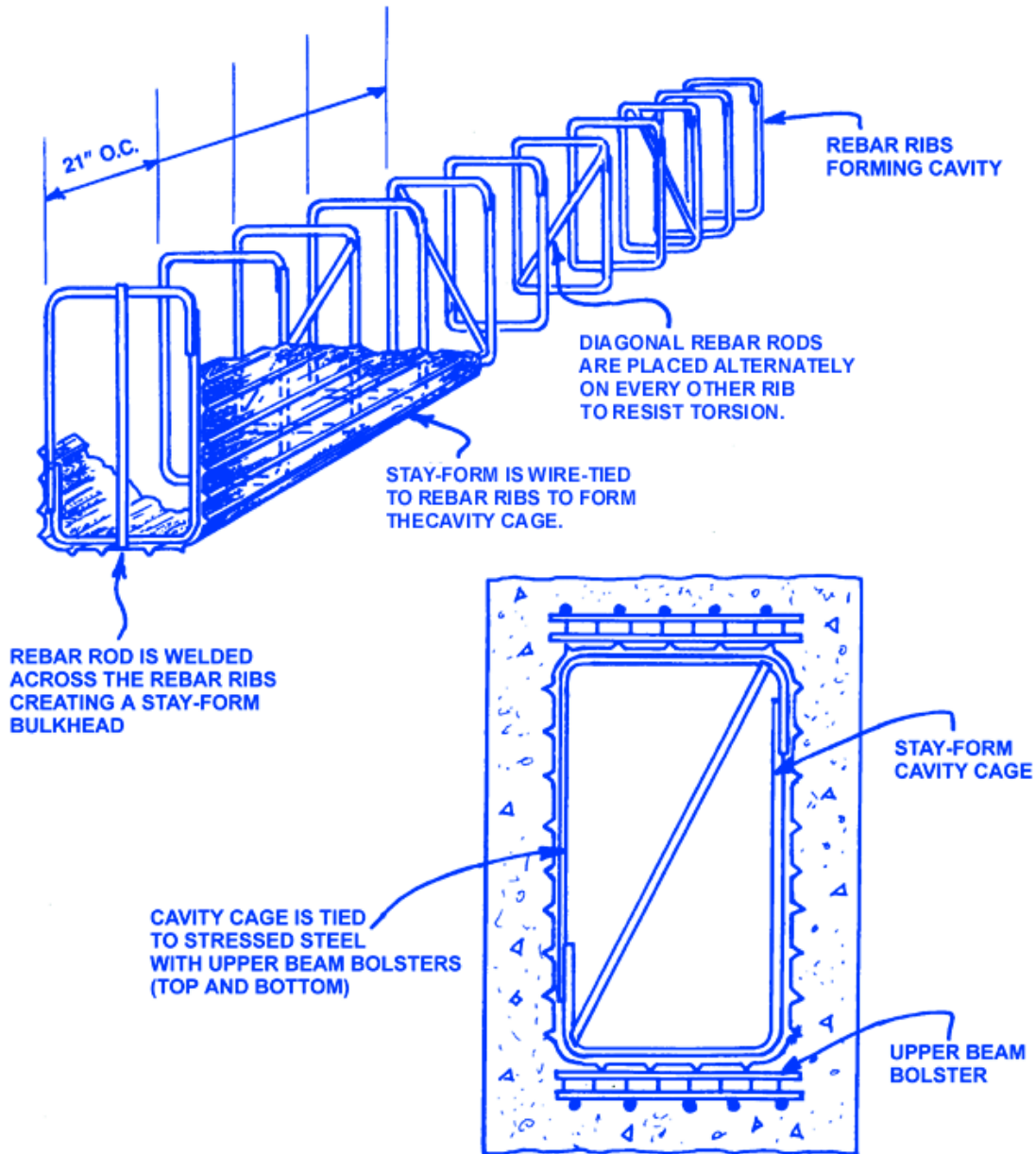

NOTE: See load table on page 3 for spacing and load information.  
It is preferable to orientate ribs into first pour.

TECHNICAL SUPPORT  
800/366-2642 ext. 205  
FAX 205/786-6527



Page 30

SALES DEPARTMENT  
800/366-2642