

STAY-FORM

The Stay-in-Place Concrete Form

FORMING WALL OR SLAB BULKHEAD / CONSTRUCTION JOINT WITH KEYWAY & WATER STOP USING STAY-FORM

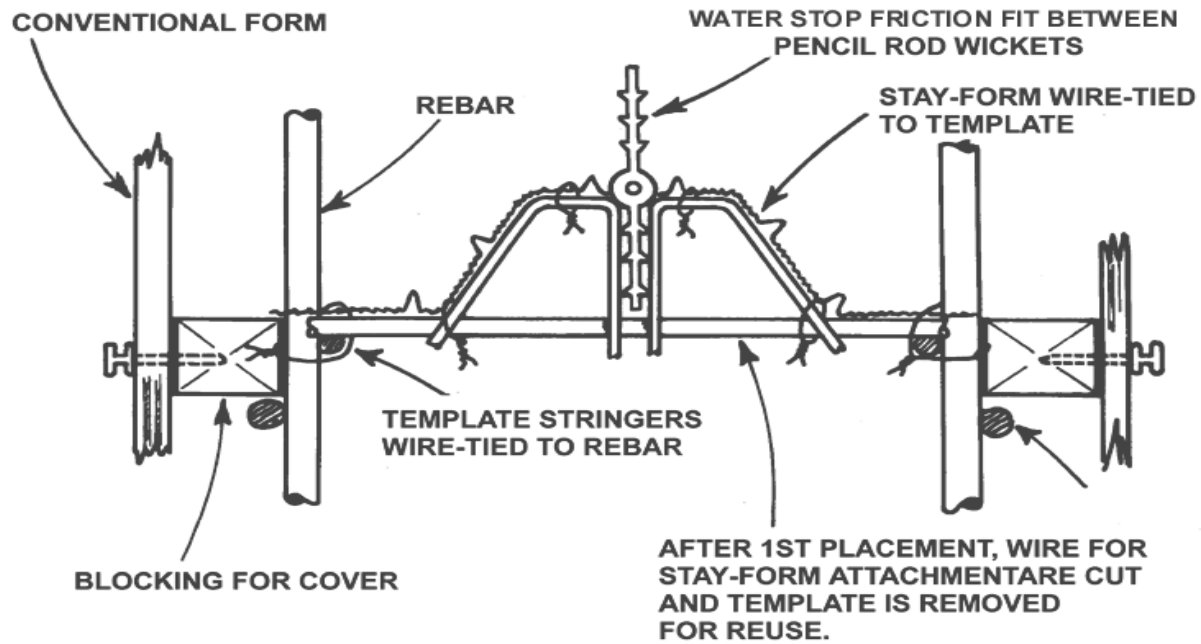

REUSABLE PENCIL ROD IS WELDED TO #4 CROSSRODS WHICH, IN TURN ARE WELDED TO THE #4 STRINGERS TO FORM A TEMPLATE ON WHICH TO FORM A STAY-FORM WALL OR SLAB BULKHEAD.

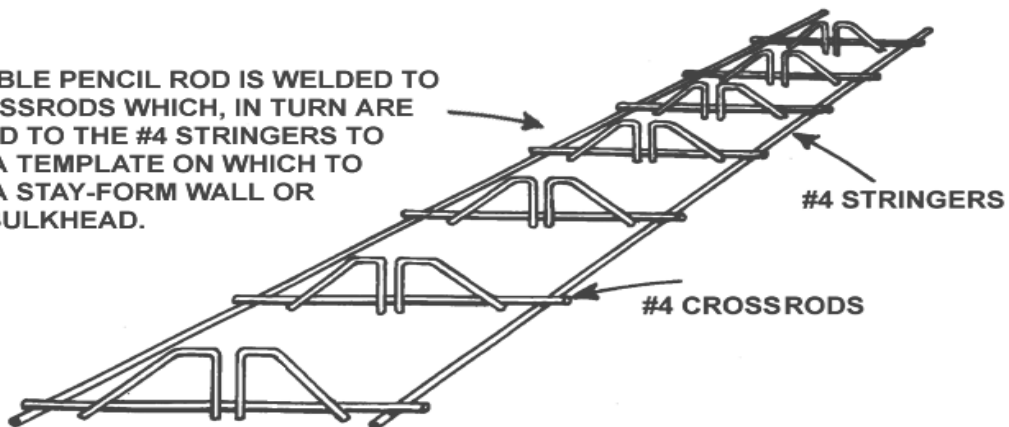

NOTE: See load table on page 3 for spacing and load information.
It is preferable to orientate ribs into first pour.

TECHNICAL SUPPORT
800/366-2642 ext. 205
FAX 205/786-6527



Page 20

SALES DEPARTMENT
800/366-2642